



WE ARE
COMMERCIAL

FOR LEASE *EXCEPTIONAL LOCATION*

6852 , 66 Street Red Deer



PRESENTED BY

CAM TOMALTY

403.350.0075
cam@remaxcprd.com

JEREMY MAKILA

403.373.7333
jeremy@remaxcprd.com

WWW.REDDEERCOMMERCIAL.COM

THE PROPERTY

6852 - 66 STREET, RED DEER

Exceptional Location for this brand new building in the busy Oriole Park West area just off the traffic circle at Orr Drive and 66th Street.

This building is available for lease for the full 2,935 Square feet in total or the individual units of 1,098.3 SF and 1,836.8 SF.

Neighboring businesses include Holiday Inn express, Best Western Plus Inns and Suites, Tim Horton's, Mcdonald's, Horizon Family Medicine, and the brand new GolfZone, Hash Breakfast Eatery and Forno Italian.



ABOUT THIS PROPERTY

Municipal	6852 66 Steet
Legal Description	Plan 9724066 Block 1 Lot 14
Size	1,098.3 Square Feet / 1,837 Square Feet
Parking	Paved Client Parking
Zoning	C4 - Commercial
Lease Rate	\$18.00/ SF
Opertaing Costs	Estimated \$10 per Square Feet
Monthly Rent	\$28.00/SF monthly



LOCATION / FLOOR PLAN

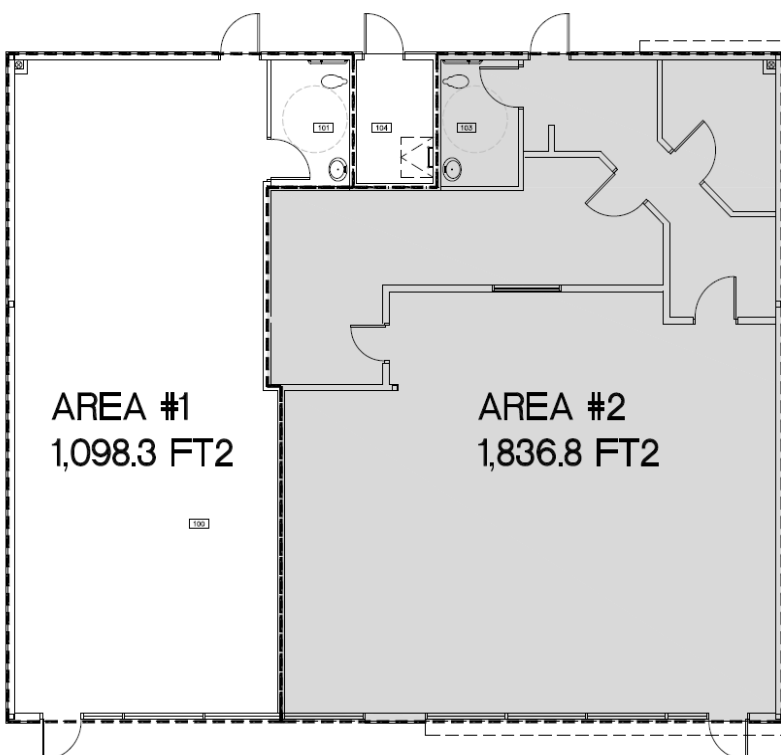
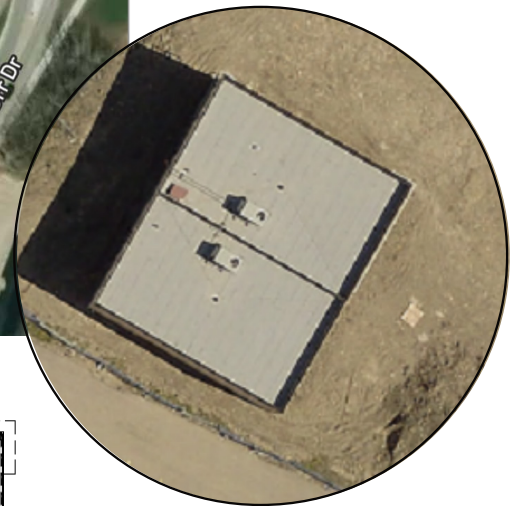

RE/MAX
COMMERCIAL
PROPERTIES

**CALGARY & RED DEER'S
ONLY EXCLUSIVE
RE/MAX COMMERCIAL BROKERAGE**



CAM TOMALTY

Senior Associate

403 350 0075

cam@remaxcprd.com

JEREMY MAKILA

Senior Associate

403 373 7333

jeremy@remaxcprd.com

DONNA CLARK

Licensed Assistant

403 986 7777

donna@remaxcprd.com

ANNIKA GARDNER

Unlicensed Assistant

403 986 7777

annika@remaxcprd.com

RED DEER

**#401, 4911 51 Street
Red Deer, AB T4N 6V4**

403.986.7777

www.reddeercommercial.com